



## Princess Yachts 50 Flybridge

Make:	Princess Yachts	Hull Material:	Fibreglass (GRP)
Model:	50 Flybridge	Draft:	1.27 m
Length:	15.37 m	Engine Model:	D11-670
Year:	2009	Engine Hours:	320, 320
Condition:	Used	Fuel Type:	Diesel
Location:	Italy	Number:	4852101
		Tax Status:	Leasing



### Description

---

This Princess 50 is in very good conditions, very lightly used and has been maintained and looked after in the right way. She's fitted with 2 x D11-670 Volvo Penta diesel engines with 320 hours (19/10/2014).

The price is very interesting considering the general conditions and the equipment the yacht has and therefore we very highly recommend an early viewing on board. For sure you won't be disappointed.

## ACCOMODATIONS:

Lay-out: 3 cabins and 2 heads + skipper cabin with private head

Serotina Cherry interior wood satin finish with teak galley floor, "AZTEC BROWN" galley worktop, external cushions (cockpit, flybridge and sunpad) and interior in ultraleather "ALMOND", carpet (saloon and cabins) "BERBER IVORY".

## MAIN DECK:

Saloon with U-shaped sofa and furniture with TV storage opposed, forward dining area with table and sofa.

## LOWER DECK:

*GALLEY:* no.1 big stainless steel portholes - drawers - refrigerator/freezer - dish washer - washing machine - sink - microwave with grill function - burner

*MASTER CABIN:* no. 3 vertical big stainless steel portholes (3 for each side) - drawers - wardrobe - direct access to master en-suite toilet room with separate shower box, teak shower grating bath accessories, electric WC and discharge system for shower water

*VIP CABIN:* no. 2 big stainless steel portholes - double bed - drawers - wardrobe - direct access to guest toilet room with separate shower box

*GUEST CABIN:* in this moment she's fitted as walk-in closet

## Measurements

---

Cruising Speed:	27 kn	Displacement:	19000
Max Speed:	30 kn		kg
LOA:	15.37 m	Displacement Type:	Dry Load
LWL:	14.95 m	Windlass:	Electric
Beam:	4.57 m		Windlass
Min. Draft:	1.27 m	Electrical Circuit:	24V
Max Draft:	1.27 m	Liferaft Capacity:	6
		Fuel Tanks #:	1
		Fuel Tanks Cap.:	2275 L
		Fuel Tanks Material:	Stainless
			Steel
		Fresh Water Tanks #:	1
		Fresh Water Tanks Cap.:	592 L
		Fresh Water Tanks Material:	Plastic
		Holding Tanks #:	1
		Holding Tanks Material:	Plastic
		Number of Cabins:	3
		Number of Bathrooms:	2
		Number of Heads:	2

## Propulsion

---

### Engine #1

Engine Make:	VOLVO PENTA	Engine Year:	2009
Engine Model:	D11-670	Hours:	320
Primary Engines:	Inboard	Power:	670 hp
Drive Type:	V Drive	Propeller Type:	4 Blade
Location:	Port		

### Engine #2

Engine Make:	VOLVO PENTA	Engine Year:	2009
Engine Model:	D11-670	Hours:	320
Primary Engines:	Inboard	Power:	320 hp
Drive Type:	V Drive	Propeller Type:	4 Blade
Location:	Starboard		

## Features

---

### Electronics

- Depthsounder - RAYMARINE ST60 WITH RAYMARINE DSM300 SENSOR
- Radar - RAYMARINE RD418HD RADAR ANTENNA
- Log-Speedometer - RAYMARINE ST60
- Computer
- TV Set
- DVD Player
- Plotter - RAYMARINE E120W
- Radio
- CD Player
- Autopilot - RAYMARINE ST6002
- Cockpit Speakers
- Compass - RITCHIE
- VHF - SIMRAD RS87
- GPS - RAYMARINE RAY85AR 125 PLUS ANTENNA

### Inside Equipment

- Stern Thruster
- Dishwasher
- Bow Thruster
- Washing Machine
- Electric Bilge Pump
- Oven
- Manual Bilge Pump
- Microwave Oven
- Air Conditioning - IN ALL CABINS INCLUDING SKIPPER CABIN
- Electric Head
- Heating
- Hot Water
- Refrigerator
- Deep Freezer
- Battery Charger - 60amp

### Electrical Equipment

- Shore Power Inlet
- Generator - ONAN 11kW

### Outside Equipment/Extras

- Teak Cockpit
- Cockpit Shower
- Hydraulic Gangway - BESENZONI 2,75mt WITH REMOTE CONTROL
- Tender - 3,20mt WITH OUTBOARD ENGINE YAMAHA 4hp
- Lifteraft
- Cockpit Cushions - ULTRALEATHER
- Cockpit Table
- Swimming Ladder

### Covers

- Cockpit Cover

## COCKPIT

---

- Self-draining
- Upholstered seat
- Cockpit lighting
- Cockpit cover
- Stainless steel handrails
- Lockable gas strut assisted hatch to lazarette/optional crew cabin
- Lockable gas strut assisted hatch to engine room
- Transom door leading to bathing platform
- 220/240v shore support inlet
- Transom bathing platform with foldaway swimming ladder, hot and cold shower
- Dinghy chock system
- Remote fuel cocks located in locker
- Storage locker for fenders and liferaft (not supplied)
- Steps to side deck
- Reserve manual bilge pump with valve chest in locker
- Integral stairway to flybridge with teak treads

## SALOON

---

- All cabins feature opening portholes and 240v power points
- All bathrooms feature electric quietflush toilets and 240v shaver points

## DECK SALOON

- U-shaped sofa with storage drawers
- Coffee table
- Sideboard unit
- Bottle and glass storage
- LCD TV
- Stereo radio/CD/DVD with saloon and exterior speakers
- Triple stainless steel framed sliding doors to cockpit for maximum opening
- Tinted side windows
- Curtains to sliding doors
- Venetian blinds or curtains to saloon windows
- Overhead downlighters

- Dining area with U-shaped sofa and table
- Clock and barometer

## **ELECTRICAL SYSTEM**

---

### **24 Volt:**

- 2 x heavy duty batteries for engine starting
- 4 x heavy duty auxiliary batteries
- Engine alternators charge both banks of batteries via blocking diodes
- 60-amp 24v float battery charger to auxiliary batteries, 5-amp 24v float battery charger to engine start batteries
- Remote battery isolator control switches at main switch panel position
- 24v to 12v converters for certain navigation and radio circuits
- Circuit breakers on all circuits

### **220/240 Volt:**

- 11 kW Diesel generator in sound shield with water cooled specially silenced exhaust
- Automatic fire extinguisher
- Shore support inlet in cockpit locker with storage for cable
- Polarity check system
- Generator/ shore support change-over controls at main control panel
- Earth leakage safety trip
- Circuit breakers on all circuits
- Power points in: - owner's stateroom - guest suite - galley (double) - saloon (2)
- Shaver points in both bathrooms

## **GALLEY**

---

### **GALLEY:**

- Avonite "AZTEC BROWN" worktop
- 4-zone ceramic hob
- Hob extractor fan
- Combination microwave/conventional oven with grill
- Stainless steel sink with mixer tap
- Chopping board

- Full height refrigerator/deep freeze
- Waste disposal bin
- Overhead downlighters and task lighting
- Drawers and storage cupboards
- Dedicated cutlery drawer
- Dedicated crockery stowage
- Dish washer
- Washing machine

## ENGINE ROOM

---

### ENGINE ROOM:

- 4-bladed aquafoil propellers in nickel aluminum bronze
- 110kgf bow thruster with dual station controls
- stern thruster with dual station remote controls
- Engine room lighting
- Power-assisted hydraulic steering system
- Lockable access hatch and ladder from cockpit to engine room
- Trim tabs with indicators
- Electronic engine and gear shift controls
- Engine room extractor fan with electronic time delay

## DECK EQUIPMENT

---

### DECK EQUIPMENT:

- Teak-laid deck, cockpit, transom platform and flybridge stairway and stairs to side decks
- Reversible electric anchor winch with foredeck, main helm and flybridge controls
- Self-stowing 20kg Delta anchor with 60 metres of chain
- Stemhead roller with automatic anchor launch and retrieve
- Deck hatch access to chain locker
- Bow rope stowage locker
- Stainless steel bow, stern and spring cleats
- Stainless steel bow fairleads
- Stainless steel pulpit and guard rails with fender baskets

- Stainless steel coachroof and flybridge handrails
- Foredeck hatch
- Quick mooring winches
- Stainless steel rubbing band with rubber insert
- Full set of IMCO navigation lights
- Riding light
- Twin beam searchlight with dual-station remote controls
- Twin electric horns
- Loud hailer/intercom
- Fuel and water fillers
- Coachroof sunbed recess
- Fender baskets on transom platform
- Besenzoni hydraulic gangway

## FLYBRIDGE

---

- Bimini Top
- Set of covers for flybridge
- Dual station instruments and controls (see Lower Helm Position)
- Helm position featuring adjustable wheel
- Twin helm seats with fore and aft adjustment
- Audible and visual alarm for bilge pumps
- Chart table
- Large U-shaped upholstered seating
- Table
- Aft sunbed with cushions and stowage space below
- Loudspeakers linked to saloon stereo
- Hatch to aft cockpit
- Wind deflector screens
- Stainless steel handrails
- GRP radar arch
- Console and seat covers
- Twin matching whip aerials for
- VHF/RT and radio



- Wet bar with electric barbecue, stowage, sink, hot and cold water supply
- Refrigerated top loading cool box

## OTHERS ITEMS

---

- Racor filter for engines
- Air-conditioning in all cabins including skipper cabin
- Cockpit cover
- Safety equipment
- Camera in engine room
- Additional bilge pump in engine room
- GLOMEX-Sat 9100 Sat-antenna
- EPIRB (to renew)
- Water direct inlet from the dock with bypass of water tank
- ONAN 11kW generator
- 2 Quick mooring winches

## LOWER HELM POSITION

---

- Twin helm seats with fore and aft adjustment for helmsman
- Instrument console with engine instruments and fuel gauges
- Helm position featuring adjustable wheel
- Dual station instruments and controls at Flybridge and Lower Helm Positions:
- rudder position indicator
- electronic engine controls
- audible and visual and audible
- engine warning system
- power-assisted electro hydraulic steering
- bow thruster control
- anchor winch remote control
- trim tab controls with indicators
- autopilot
- VHF with DSC R/T and intercom to flybridge
- speed and distance log
- echo sounder with alarm

- remote control searchlight
- high speed magnetic compass
- horn button
- automatic foghorn with loudhailer
- Chart table with light and chart stowage
- Windscreen wipers with freshwater windscreen wash system
- Bilge pump controls with visual pump running warnings
- 24v and 220/240v electrical control panels
- Clear glass toughened windscreen for good low light vision
- Black mesh sunscreens
- Riding light, helm and navigation light control switches
- Stowage under helm seat
- 12v outlet

## Declinazione di responsabilità standard

---

The Company offers the details of this vessel in good faith but cannot guarantee or warrant the accuracy of this information nor warrant the condition of the vessel. A buyer should instruct his agents, or his surveyors, to investigate such details as the buyer desires validated. This vessel is offered subject to prior sale, price change, or withdrawal without notice.

## Photos

---



Manufacturer Provided Image











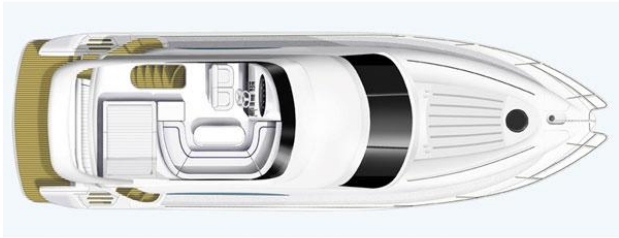

Manufacturer Provided Image: Flybridge



Manufacturer Provided Image: Main Deck Layout

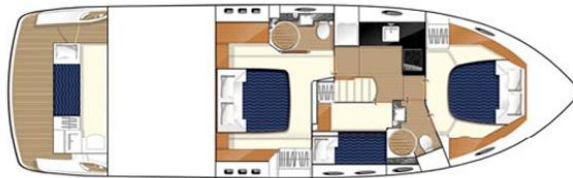

Manufacturer Provided Image:  
Accommodation Layout