



AMER F100

CATEGORY: USED

TYPE: MOTOR YACHT

LOA: 30.00 M

BEAM: 7.00 M

DRAFT: 1.95 M

FULL DISPLACEMENT: 85 T

YEAR: 2020

REFIT: 2024

FLAG: ITALIAN

TYPE: COMMERCIAL

VAT: UNPAID

GENERAL DESCRIPTION

THE AMER F100, BUILT BY PERMARE SHIPYARD IN 2020, IS A 30-METER LUXURY MOTOR YACHT THAT COMBINES ITALIAN ELEGANCE WITH ADVANCED TECHNOLOGY. POWERED BY FOUR VOLVO PENTA IPS1200 ENGINES, IT REACHES A TOP SPEED OF 28 KNOTS AND CRUISES COMFORTABLY AT 23 KNOTS, OFFERING EXCEPTIONAL EFFICIENCY AND MANEUVERABILITY. THE YACHT ACCOMMODATES UP TO 10 GUESTS IN 5 CABINS, INCLUDING A MASTER SUITE, 2 VIP STATEROOMS, AND 2 TWIN CABINS (CONVERTIBLES), ALL WITH EN-SUITE FACILITIES, ALONG WITH 5 CREW MEMBERS IN 3 CREW CABINS. FEATURING A SPACIOUS SALOON WITH PANORAMIC WINDOWS, A WELL-EQUIPPED FLYBRIDGE WITH DINING AND SUNBATHING AREAS, A HYDRAULIC SWIM PLATFORM, AND SEAKEEPER STABILIZERS FOR ULTIMATE COMFORT, THE AMER F100 IS AN OUTSTANDING CHOICE FOR LUXURY YACHTING.

KEY FEATURES • 5 CABINS LAYOUT (ALL DOUBLES) • REFIT 2024 • 1000 ENGINE HOURS • LOW CONSUMPTION • DOUBLE STABILIZERS • JACUZZI ON THE FLYDECK.

PROPULSION, FUEL AND TRASMISSIONS

N° ENGINES: 4

ENGINE POWER: 1200 HP

ENGINE MODEL : VOLVO PENTA IPS 1200 HP

ENGINE HOURS: 1000

ENGINE BRAND: VOLVO PENTA

N° TANKS: 1

CAPACITY: 8.500 L

FUEL: DIESEL

CONSUMPTION: 40 L/H
AT ECONOMIC SPEED 9 KN

PROPELLER: 5 SHADES

TRASMISSION: IPS

CRUISING SPEED: 23 KN

MAX SPEED: 28 KN

MATERIALS

HULL : GRP

DECKHOUSE : GRP

DECK: TEAK

IDRAULICS

WATER TANK: 1 X 2000 L
DESSALATOR: PRESENT

FRESH WATER MAKER: IDROMAR 2X250 L/H
AUTOCLAVES: 2

TYPE BOILER: 6 ELETTRICS
BOILER: 6X65 LT

ELETTRICS

VOLTAGE: 220 / 24 VOLT

N° BATTERIES: 26 + 8 ENGINE + 2 GENERATORS
8 EMERGENCY + 2 RADIO

AIR CONDITIONING: FRIGOMAR

GENERATORS: 2 X FISHERPANDA 32 KW

CHARGE BATTERIES: 3 + 4 ENGINE
+2 GENERATORS + 1 EMERGENCY + 1 RADIO + 2 INVERTER

INVERTER: PRESENT

DESCRIPTION INTERIORS

CABINS 5

-THE AMER F100 OFFERS EXCEPTIONAL ACCOMMODATIONS DESIGNED WITH LUXURY AND COMFORT IN MIND, ENSURING AN UNFORGETTABLE EXPERIENCE FOR GUESTS. THE YACHT FEATURES FIVE BEAUTIFULLY APPOINTED CABINS THAT CAN HOST UP TO 10 GUESTS, EACH BOASTING MODERN FURNISHINGS, PREMIUM MATERIALS, AND EN-SUITE BATHROOMS FOR PRIVACY AND CONVENIENCE.

- **MASTER SUITE:** LOCATED ON THE MAIN DECK, THE MASTER SUITE IS A HAVEN OF ELEGANCE AND SPACE, FEATURING LARGE PANORAMIC WINDOWS THAT FLOOD THE ROOM WITH NATURAL LIGHT, A KING-SIZE BED, A PRIVATE SEATING AREA, AND A LUXURIOUS EN-SUITE BATHROOM WITH HIGH-END FITTINGS.
- **VIP STATEROOMS:** TWO VIP STATEROOMS ARE SITUATED ON THE LOWER DECK, EACH OFFERING GENEROUS SPACE, QUEEN-SIZE BEDS, AND EN-SUITE BATHROOMS WITH SLEEK CONTEMPORARY DESIGNS, ENSURING A FIRST-CLASS EXPERIENCE FOR GUESTS.
- **DOUBLE CABINS:** ALSO LOCATED ON THE LOWER DECK ARE TWO DOUBLE CABINS, IDEAL FOR FAMILIES OR ADDITIONAL GUESTS. THESE CABINS ARE THOUGHTFULLY DESIGNED WITH DOUBLE BEDS, AMPLE STORAGE, AND EN-SUITE BATHROOMS.

THE CREW QUARTERS, DISCREETLY SEPARATED FROM THE GUEST AREAS, ACCOMMODATE UP TO 5 CREW MEMBERS IN 3 CABINS, ENSURING SEAMLESS SERVICE. EVERY ASPECT OF THE ACCOMMODATIONS ON THE AMER F100 REFLECTS ATTENTION TO DETAIL, CREATING A HARMONIOUS BALANCE OF LUXURY, COMFORT, AND FUNCTIONALITY.

EQUIPMENT

- FULLY INTEGRATED NAVIGATION SYSTEM (SIMRAD, RAYMARINE, OR GARMIN DEPENDING ON CUSTOMIZATION)
- RADAR, AUTOPILOT, AND GPS CHART PLOTTER
- VHF RADIO WITH DSC
- ELECTRONIC ENGINE CONTROL SYSTEMS
- DEPTH SOUNDER AND SPEED LOG
- SEAKEEPER GYROSCOPIC STABILIZERS FOR REDUCED ROLL AT ANCHOR AND UNDERWAY
- AIR CONDITIONING SYSTEM THROUGHOUT (HOT AND COLD ZONES)
- HIGH-QUALITY SOUNDPROOFING FOR REDUCED NOISE LEVELS
- PANORAMIC WINDOWS IN THE SALOON AND MASTER SUITE
- LED AMBIENT LIGHTING
- ENTERTAINMENT SYSTEM WITH SMART TVs AND SURROUND SOUND
- FULLY EQUIPPED GALLEY WITH PREMIUM APPLIANCES
- UNDERWATER LED LIGHTS FOR A STUNNING NIGHTTIME EFFECT
- WI-FI SYSTEM FOR CONNECTIVITY THROUGHOUT THE YACHT
- OPTIONAL OPTIONS LIKE A JACUZZI OR UPGRADED AV/IT SYSTEMS,
- EXPANSIVE FLYBRIDGE WITH DINING AREA, WET BAR, AND SUNBATHING SPACES
- TEAK DECKING ON ALL EXTERIOR AREAS
- HYDRAULIC SWIM PLATFORM FOR TENDER LAUNCHING AND WATER ACCESS
- FOREDECK SUNBATHING AND SEATING AREA WITH RETRACTABLE BIMINI
- GARAGE FOR TENDER AND WATER TOYS
- ELECTRIC MOORING WINCHES AND CAPSTANS
- FIRE DETECTION AND SUPPRESSION SYSTEMS
- LIFE RAFTS AND LIFE JACKETS FOR ALL PASSENGERS AND CREW
- BILGE PUMP SYSTEM (AUTOMATIC AND MANUAL)
- ADVANCED ALARM MONITORING SYSTEM
- WATERMAKER FOR EXTENDED CRUISING AUTONOMY
- GENERATOR (TYPICALLY ONAN OR KOHLER) FOR POWER AT ANCHOR
- BOW AND STERN THRUSTERS FOR ENHANCED DOCKING CONTROL
- SHORE POWER CONNECTION WITH CONVERTER

REFIT 2024

IN 2024, THE AMER F100 UNDERWENT A REFINED AND TASTEFUL REFIT TO ENHANCE ITS AESTHETIC APPEAL AND COMFORT WHILE PRESERVING ITS ORIGINAL ELEGANCE. THE YACHT’S HULL WAS EXPERTLY WRAPPED IN A SOPHISTICATED NAVY BLUE, PROVIDING A STRIKING VISUAL TRANSFORMATION WHILE METICULOUSLY PRESERVING THE PRISTINE ORIGINAL WHITE FINISH BENEATH. ON THE FLYBRIDGE, A BESPOKE NEW SOFA WAS CRAFTED AND INSTALLED, OFFERING BOTH STYLE AND FUNCTIONALITY TO ELEVATE THE OUTDOOR LOUNGING EXPERIENCE. INSIDE, THE INTERIOR SPACES WERE ENRICHED WITH THE ADDITION OF LUXURIOUS NEW CHAIRS, SEAMLESSLY BLENDING CONTEMPORARY DESIGN WITH THE YACHT’S TIMELESS AMBIANCE. FURTHER ENHANCING THE INTERIOR DÉCOR, CAREFULLY SELECTED STATUES WERE INTRODUCED, ADDING A TOUCH OF ARTISTIC SOPHISTICATION AND CREATING AN EVEN MORE INVITING AND EXCLUSIVE ATMOSPHERE FOR GUESTS. THIS REFIT UNDERSCORES A COMMITMENT TO MAINTAINING THE YACHT’S IMPECCABLE STANDARDS WHILE INTRODUCING THOUGHTFUL UPGRADES TO ENSURE A TRULY LUXURIOUS EXPERIENCE.











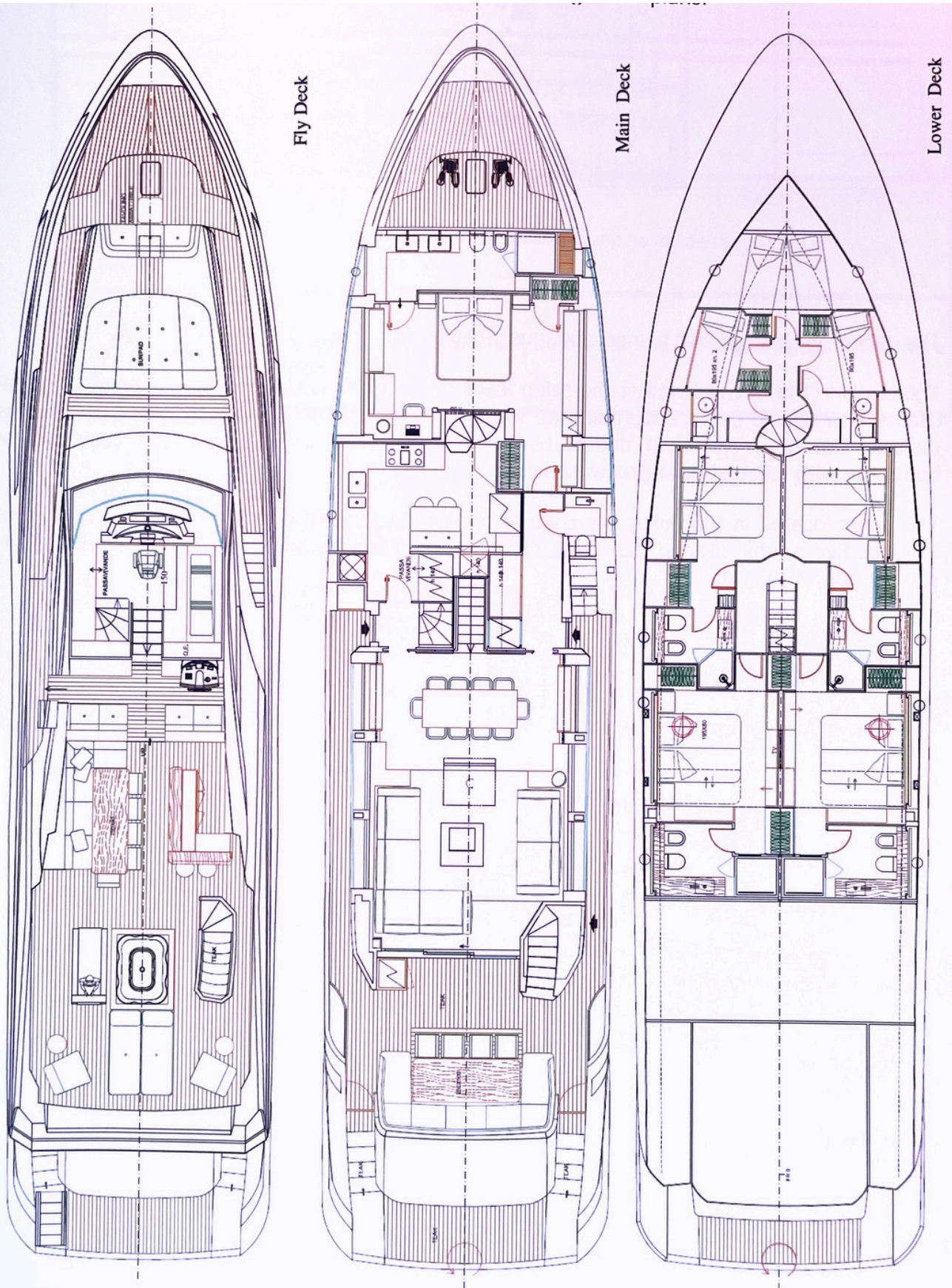

Figure 3-1– General Plans

Rev.1 08.06.2020

37 | 209





