

RIVA CORSARO 100 HULL 21



Defined by her elegance and luxury, it is difficult to ignore the Riva Corsaro. Working closely with Officina Italiana Design with an ingenious fusion of comfort and performance, technology and design, safety and style.

YEAR	:	2021
L.O.A.	:	29,90 m
BEAM	:	6,70 m
DRAFT	:	2,35 m
WEIGHT	:	110,000 kg
DIESEL	:	9000 litres
WATER	:	1320 litres
ENGINES	:	2 x MTU 16V 2000 M96 Power 2638 mhp / 1939 KW
HOURS	:	603 h
FLAG	:	Cayman islands
LYING	:	Spain
PRICE	:	9.600.000,00€ VAT PAID

All particulars are believed to be correct, but not guaranteed.

RIVA CORSARO 100

LAYOUT:

5 CABINS (1 master cabin, 2 vip cabin 1 guest cabin, 2 crew cabin) + 6 BATHROOM

NAVIGATION:

Autopilot Simrad AP70
Chartplotter N°2 Simrad NSO
N°2 Simrad NSS Evo3
Compass N°1 Magnetic compass Riviera
Depth Sounder N°2 Simrad Sonar Echo - Airmar DST
GPS N°2 Simrad GS25
Odometer N°2 Simrad - Airmar
Radar Simrad Halo Pulse - Antenna 6ft
VHF Radio N°2 Simrad RS90

EQUIPMENT:

Riva metallic color for hull + deck + aft regal silver color.
Custom internal timber (striped canaletto walnut 10 gloss).
Master bathroom: marble crema delicato in substitution of standard corian.
Bulkwards side opening.
Portside forward guest cabin: manual sliding bed to convert the twin beds into a double bed.
Flybridge - aft terrace: manual bimini with 6 carbon fiber poles.
Main deck - foredeck: manual bimini with 4 carbon poles.
Hydraulic stern thruster.
Cockpit: additional helm station (bow and stern thruster installed).
Additional thermal protection for the superstructure (upgrade).
Additional flush cleats (2) for cross mooring at aft.
Engines MTU 2638 hp - diff. than standard.

All particulars are believed to be correct, but not guaranteed.

RIVA CORSARO 100

Salon's electric sliding door.

Electric curtains in whole boat (excluding bridge, galley, crew area and bathrooms).

Blackout curtains with electric motion in all cabins (crew cabins not included).

Super tropic air condition

Automatic battery charger for generators.

Generators upgrade: 35kw generators (2) in substitution of 28kw (2).

Gyroscopic stabilizers.

Dimmer switch for internal and external lighting (crew area, technical areas, navigation lights, service lights, courtesy lights, bathrooms and galley not included).

Additional water maker 180 l/h with remote control.

Stern underwater lights (4) - white color.

Side underwater lights (7 for each side) - white color.

Weather meteo station with repeater in bridge.

AIS furuno system.

Salon - Coffee table - as per Riva 100' Standard, to be sole leather upholstered. Same leather and color as chosen for the interior areas.

Salon - Armchairs (2) - custom armchairs (Knoll, Barcellona, upholstery in white leather).

Salon - Minotti Andersen sofa - throw pillows.

Dining area - Floor: marble Ocean Storm diff. than standard carpet.

Dining area - Forward wall - to remove the standard mirror in the upper part of the furniture.

Furthermore standard lacquered vertical panel in the niche to be replaced with mirror.

Dining area - Table: Cassina Le Corbusier, top in crystal clear and structure in matt black color.

Dining area - Dining chairs - custom chairs - Fendi Home, Blixen, back & seat in Fendi leather Vermont Luxe 546 Quartz grey.

Lower deck bathrooms: custom marble Eramosa to replace the standard corian.

Sole leather upholstery for main deck and lower deck:

Tabacco C31 sole leather with stitching in color 399.

Carpet Supertuft Fiord 5522 to replace standard carpet in all areas where carpet is foreseen as per standard design.

Floor: standard Corian to be replaced with custom corian Dupont Aspen.

RIVA CORSARO 100

Low furniture/cabinets - to add silicon finish to avoid any dirt to go beyond the base itself.

Aft entrance door inside curtain

Roman style curtains, Fabric Zimmer & Rhode Fox col. 981.

Roman style curtains, Fabric at lower deck cabins

Aluminium Venetian blinds, color White/Bianco B101 at Galley

Aluminium Venetian blinds, color White/Bianco B101 at bathrooms

Foredeck windlass break to be longer than as per standard.

Fender holders by Canalicchio, as follow: 8 x fender holder model "lineare" and 4 x fender holder model "sagomati con distanziale".

Aft cockpit camera Samsung AHCV-607R, view field around 350°.

Upholstery of cushions of fixed furniture: fabric Marmo Artic Salon, dining area and Master cabin: electric leather venetian blinds.

DOMESTIC :

Galley: wine cellar 34 bottles 0,75 l.

Galley: 90 cm appliances (extraction hood, cooking top and oven).

Galley: microwave oven.

Custom fridge without the ice-cube maker.

Flybridge: ice maker.

AUDIO VISUAL:

International decoder in STBD forward guest cabin.

International decoder in portside forward guest cabin.

International decoder in STBD aft VIP cabin.

International decoder in portside aft VIP cabin.

International decoder in galley (to be combined with sat tv antenna KHV TV8)

International decoder in captain cabin.

Audio/video upgrade in STBD aft VIP cabin.

Audio/video upgrade in portside aft VIP cabin.

RIVA CORSARO 100

Audio/video upgrade in portside forward guest cabin.
Audio/video upgrade in STBD forward guest cabin.
Antenna TV SAT KVH TV8 with domes (2) and decoder in salon and master cabin.
TV 55" in salon (diff. 49").
TV 49" in master cabin (diff. 40").
Tv 49" in portside aft vip cabin (diff. 32").
TV 49" in STBD aft VIP cabin (diff. 32").
TV 49" in portside forward guest cabin (diff. 32")
Tv 28" in stbd forward guest cabin.
Tv 28" in captain cabin.

RIVA CORSARO 100

LAYOUT:

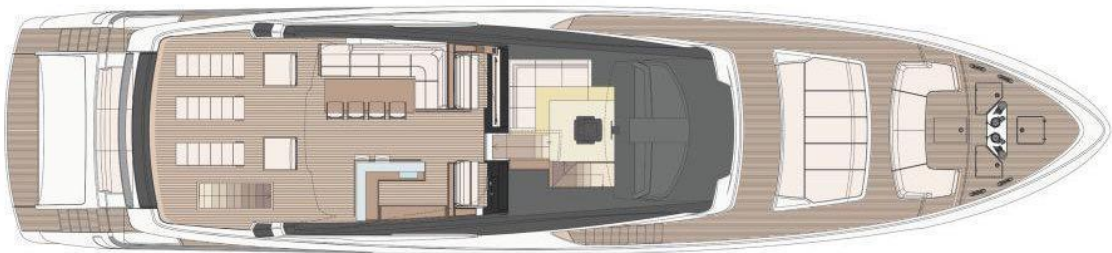

All particulars are believed to be correct, but not guaranteed.

